

Hoses

Polyurethane, rubber and “non-conductive”.

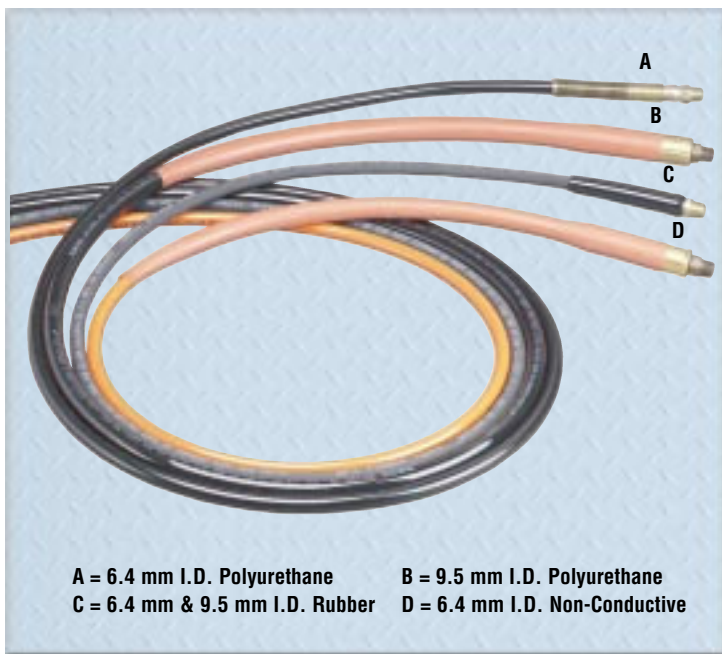

CYLINDER RETURN TIME

The figures show the relative effect two styles of hose can have on return time. Actual times may vary.

Cylinder	No. 9769 3.1 m Hose 6.4 mm I.D.	No. 9781 3.1 m Hose 9.5 mm I.D.
C2514C	51 sec.	14 sec.
C556C	1 min., 30 sec.	24 sec.
C5513C	4 min., 12 sec.	59 sec.
C10010C	6 min., 56 sec.	1 min., 3 sec.

ORDERING INFORMATION

Hose Type	Hose I.D.	Hose Length	Burst Rating	Order No.
Polyurethane	6.4 mm	0.6 m	1,400 bar	9765
Polyurethane	6.4 mm	0.9 m	1,400 bar	9766
Polyurethane	6.4 mm	1.8 m	1,400 bar	9767
Polyurethane	6.4 mm	1.8 m	1,400 bar	9764*
Polyurethane	6.4 mm	2.4 m	1,400 bar	9768
Polyurethane	6.4 mm	3.1 m	1,400 bar	9769
Polyurethane	6.4 mm	3.7 m	1,400 bar	9770
Polyurethane	6.4 mm	6.1 m	1,400 bar	9771
Polyurethane	6.4 mm	15.3 m	1,400 bar	9772
Polyurethane	6.4 mm	22.9 m	1,400 bar	9750
Polyurethane	6.4 mm	30.5 m	1,400 bar	9751
Polyurethane	9.5 mm High Flow	1.8 m	2,100 bar	9780
Polyurethane	9.5 mm High Flow	3.1 m	2,100 bar	9781
Polyurethane	9.5 mm High Flow	6.1 m	2,100 bar	9782
Polyurethane	9.5 mm High Flow	15.3 m	2,100 bar	9783
Rubber, Wire-braid	6.4 mm	0.9 m	1,400 bar	9755
Rubber, Wire-braid	6.4 mm	1.8 m	1,400 bar	9756
Rubber, Wire-braid	6.4 mm	1.8 m	1,400 bar	9754*
Rubber, Wire-braid	6.4 mm	2.4 m	1,400 bar	9757
Rubber, Wire-braid	6.4 mm	3.1 m	1,400 bar	9758

NOTE: Polyurethane hoses not recommended for use where heat or weld splatter conditions exist.
*Furnished with 9798 hose half coupler and 9800 dust cap.

- There are five styles in lengths from 0.6 to 30.5 meters. All have plastic hose guards except for the 6.4 mm I.D. polyurethane hoses which have spring guards.
- All have 3/8" NPTF fittings on both ends.
- Operating pressure is 700 bar. All comply with MHI standard IJ100.

■ Polyurethane hose

Made up of nylon core tube with polyester fiber reinforcement which will withstand the minimum SAE bend radius without shortening service life. These hoses last up to seven times longer than rubber hose, and are suitable for continuous service at temperatures from -40 to 66 C.

■ Rubber hose

2-ply rated hose reinforced with two braids of high tensile steel wire. The rubber covering is oil and weather resistant. These hoses are MSHA approved.

■ Non-conductive hose

For applications requiring electrical isolation by the hose, “non-conductive” hose has a leakage factor of less than 50 microamperes, considered a safe level on conductivity by SAE standards. The covering is polyurethane and colored orange for easy identification as non-conductive hose. The covering is not perforated, preventing moisture from entering the hose and affecting its overall conductivity. All non-conductive hoses have a minimum burst pressure of 2,800 bar.

■ Hydraulic hose assembly

No. 9764 – Hose assembly consisting of 9767 (1.8 m hose), 6.4 mm I.D. polyurethane with 9798 hose half coupler and 9800 dust cap assembled.

No. 9754 – Hose assembly consisting of 9756 (1.8 m hose), 6.4 mm I.D. rubber with 9798 hose half coupler and 9800 dust cap assembled.

Hose Type	Hose I.D.	Hose Length	Burst Rating	Order No.
Rubber, Wire-braid	6.4 mm	3.7 m	1,400 bar	9759
Rubber, Wire-braid	6.4 mm	6.1 m	1,400 bar	9760
Rubber, Wire-braid	6.4 mm	9.2 m	1,400 bar	9761
Rubber, Wire-braid	6.4 mm	15.3	1,400 bar	9762
Rubber, Wire-braid	9.5 mm High Flow	0.9 m	1,400 bar	9733
Rubber, Wire-braid	9.5 mm High Flow	1.8 m	1,400 bar	9776
Rubber, Wire-braid	9.5 mm High Flow	3.1 m	1,400 bar	9777
Rubber, Wire-braid	9.5 mm High Flow	4.6 m	1,400 bar	9734
Rubber, Wire-braid	9.5 mm High Flow	6.1 m	1,400 bar	9778
Rubber, Wire-braid	9.5 mm High Flow	9.2 m	1,400 bar	9735
Rubber, Wire-braid	9.5 mm High Flow	12.2 m	1,400 bar	9736
Rubber, Wire-braid	9.5 mm High Flow	15.3 m	1,400 bar	9779
“Non-Conductive”	6.4 mm	1.8 m	2,800 bar	9773
“Non-Conductive”	6.4 mm	2.4 m	2,800 bar	9774
“Non-Conductive”	6.4 mm	6.1 m	2,800 bar	9775
CE	6.4 mm	0.6 m	2,800 bar	9765E
	6.4 mm	0.9 m	2,800 bar	9766E
	6.4 mm	1.8 m	2,800 bar	9767E
	6.4 mm	2.4 m	2,800 bar	9768E
	6.4 mm	3.1 m	2,800 bar	9769E
	6.4 mm	3.7 m	2,800 bar	9770E
	6.4 mm	6.1 m	2,800 bar	9771E

Couplers

Standard and Flush-Face couplers

Oil
Page 78

Gauges
Page 76-77

Fittings
Page 80

Manifolds
Page 79

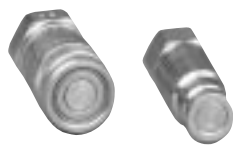

9794 Flush-Face couplers

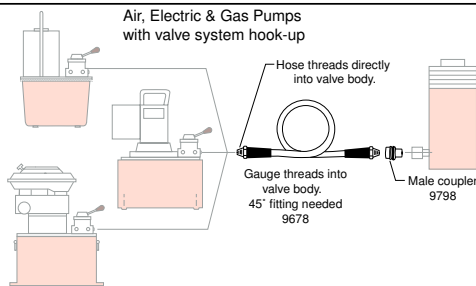
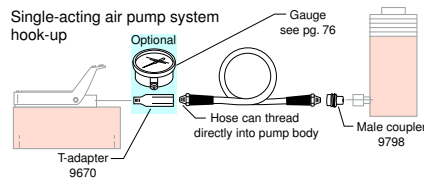
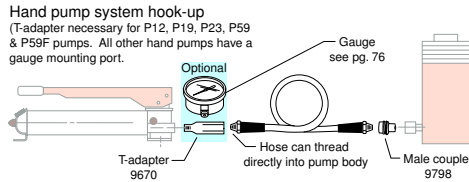
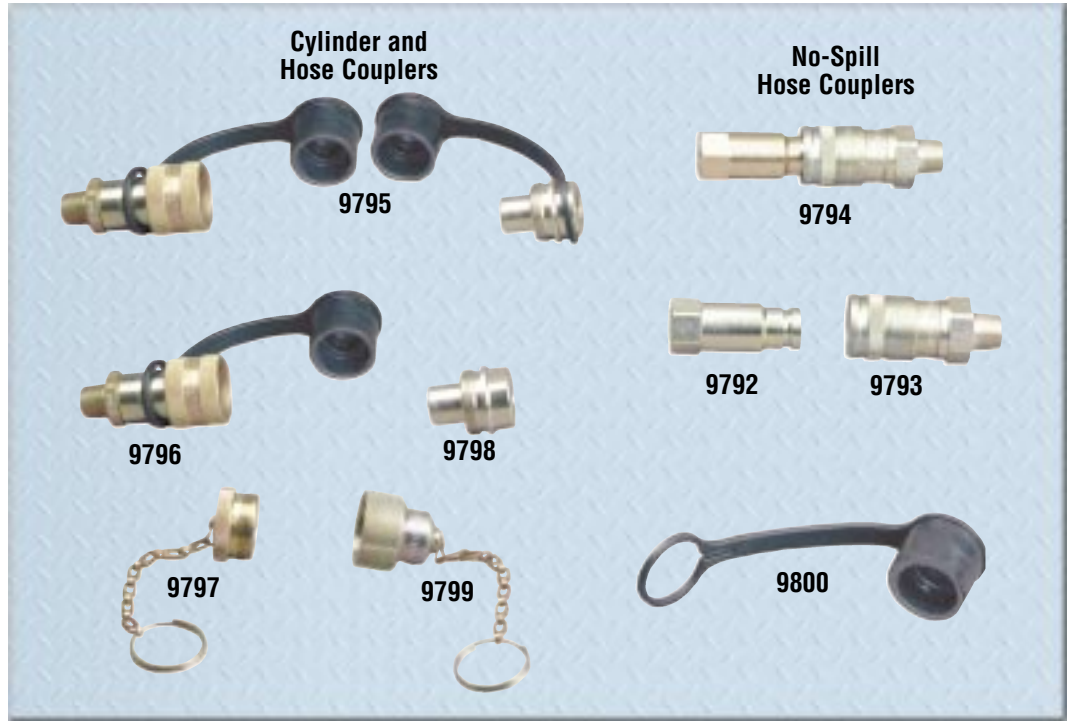

■ Cylinder and hose couplers

Designed for use up to 700 bar with hydraulic jacks, cylinders, etc. They are the threaded union type for interchanging cylinders in seconds. Each half is valved with a precision ball for a tight shutoff when disconnected. These couplers also permit the separation of cylinders or hose from pump when at 0 bar with minimal oil loss.

No. 9795 – Complete quick coupler, $\frac{3}{8}$ " NPTF. (Includes two 9800 dust caps.)

No. 9798 – Male (hose) half coupler (less hose half dust cap), $\frac{3}{8}$ " NPTF.

No. 9796 – Female (cylinder) half coupler with No. 9800 dust cap, $\frac{3}{8}$ " NPTF.

No. 9796-V – Same as 9796, but with Viton seals.

No. 9796-E – Same as 9796, but with EPR seals.

No. 9799 – Optional metal dust cap (Hose half.)

No. 9797 – Optional metal dust cap (Cylinder half.)

■ No-spill, push-to-connect hydraulic hose couplers

High flow, no-spill, push-to-connect couplers with locking collar and flush face designed for high pressure applications. The flush-face concept makes it easy to clean both coupler ends before connecting. Our unique push-to-connect, "dry-break" design eliminates oil spillage. The locking collar makes accidental disconnects a thing of the past. For 700 bar operation. Designed to permit high oil flow.

No. 9792 – Female (cylinder) half quick coupler only. Wt., 113 g.

No. 9793 – Male (hose) half quick coupler only. Wt., 113 g.

No. 9794 – Complete quick coupler (male and female). Dust caps not included. Wt., 227 g.

■ Hydraulic coupler dust cap

Dust cap fits either male or female half couplers.

No. 9800 – Dust cap. For male or female $\frac{3}{8}$ " NPTF half couplers. Wt., 113 g.