

General Purpose Cylinders (C Series)

Single-Acting, Spring-Return — 5-100 Ton Capacity

Rugged, high quality all purpose cylinder used for lifting and pressing.

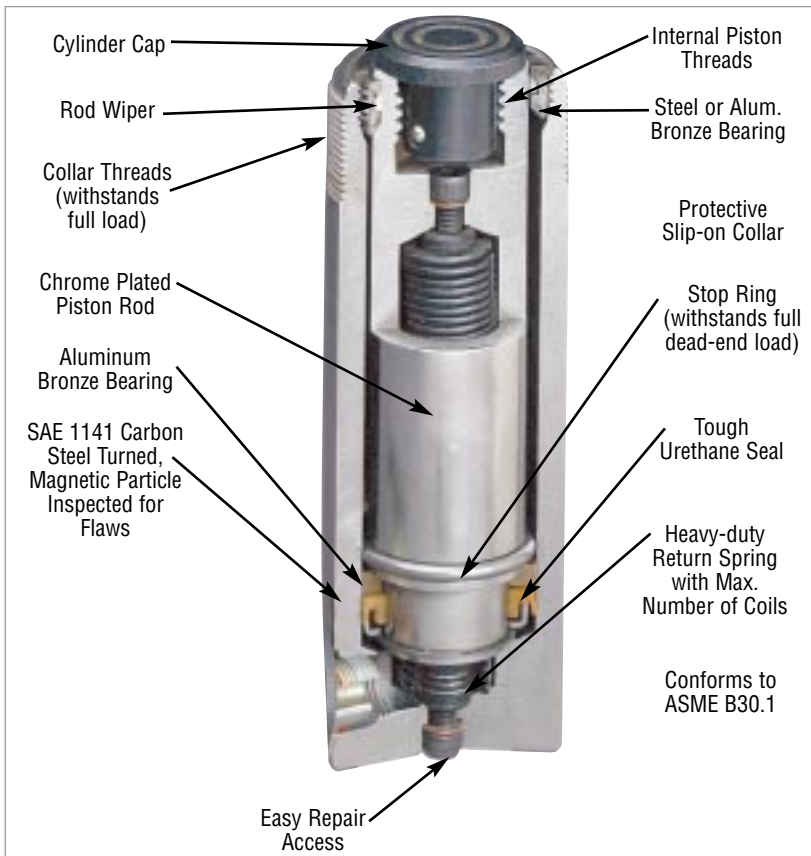
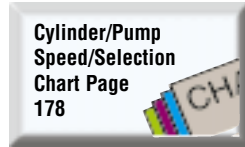

- Fully comply with ASME B30.1 standards. Have a 2 to 1 safety factor on material yield.
- Aluminum bronze bearing reduces scoring caused by off-center loads.
- Maximum sized springs speed piston return and increase spring life.
- Chrome plated piston rod resists wear and corrosion.
- Wide range of accessories available to thread onto piston rod, collar, or into cylinder base. Base mounting holes standard on 5 through 55 ton cylinders; optional on 75 and 100 ton cylinders.
- A 9796 3/8" NPTF female half coupler is standard with each cylinder. Oil ports are 3/8" NPTF.

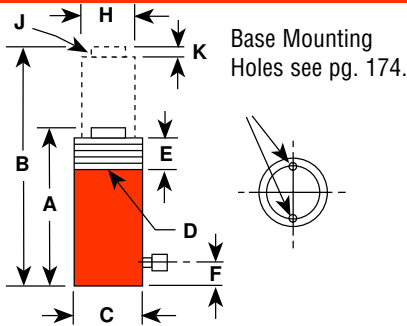

ORDERING INFORMATION

See current price list for shipping weights

Cyl. Cap. (tons)	Stroke (mm)	Order No.	Oil Cap. (cu. cm)	A	B	C	D	E	F	H	J	K	Bore Dia. (mm)	Cylinder Effective Area (sq. cm)	Internal Press. at Cap. (bar)	Metric Tons at 700 bar	Prod. Wt. (kg)
				Re-tracted Height (mm)	Ex-tended Height (mm)	Outside Dia. (mm)	Collar Thread (in.)	Collar Thread Length (mm)	Base to Port (mm)	Piston Rod Dia. (mm)	Piston Rod Int. Thread and Depth (mm)	Piston Rod Protru-sion (mm)					
5	25.4	C51C	18.0	110.3	138.1	38.1	1½-16	28.6	19.1	25.4	¾-16 x 15.9	6.4	28.6	6.4	694	4.5	1.0
5	82.6	C53C	52.4	165.1	247.7	38.1	1½-16	28.6	19.1	25.4	¾-16 x 15.9	6.4	28.6	6.4	694	4.5	1.5
5	133.4	C55C	85.2	215.9	349.3	38.1	1½-16	28.6	19.1	25.4	¾-16 x 15.9	6.4	28.6	6.4	694	4.5	1.8
5	184.2	C57C	118.0	273.1	457.2	38.1	1½-16	28.6	19.1	25.4	¾-16 x 15.9	6.4	28.6	6.4	694	4.5	2.3
5	235.0	C59C	150.8	323.9	558.8	38.1	1½-16	28.6	19.1	25.4	¾-16 x 15.9	6.4	28.6	6.4	694	4.5	2.6
10	25.4	C101C	36.1	92.1	117.5	57.2	2¼-14	28.6	19.1	38.1	1-8 x 19.1	6.4	42.8	14.4	617	10.2	1.8
10	54.0	C102C	78.7	120.7	174.6	57.2	2¼-14	28.6	19.1	38.1	1-8 x 19.1	6.4	42.8	14.4	617	10.2	2.3
10	104.8	C104C	150.8	171.5	276.2	57.2	2¼-14	28.6	19.1	38.1	1-8 x 19.1	6.4	42.8	14.4	617	10.2	3.0
10	155.6	C106C	224.5	247.7	403.2	57.2	2¼-14	28.6	19.1	38.1	1-8 x 19.1	6.4	42.8	14.4	617	10.2	4.3
10	206.4	C108C	326.2	298.5	504.8	57.2	2¼-14	28.6	19.1	38.1	1-8 x 19.1	6.4	42.8	14.4	617	10.2	5.0
10	257.2	C1010C	370.4	349.3	606.4	57.2	2¼-14	28.6	19.1	38.1	1-8 x 19.1	6.4	42.8	14.4	617	10.2	5.9
10	308.0	C1012C	444.2	400.1	708.0	57.2	2¼-14	28.6	19.1	38.1	1-8 x 19.1	6.4	42.8	14.4	617	10.2	6.6
10	358.8	C1014C	517.9	450.9	809.6	57.2	2¼-14	28.6	19.1	38.1	1-8 x 19.1	6.4	42.8	14.4	617	10.2	7.3
10	406.4	C1016C	592.0	520.7	927.1	57.2	2¼-14	28.6	19.1	38.1	1-8 x 19.1	6.4	42.8	14.4	617	10.2	8.4
15	25.4	C151C	50.8	123.8	149.2	69.9	2½-16	28.6	19.1	44.5	1-8 x 19.1	6.4	50.8	20.3	659	14.2	3.4
15	54.0	C152C	109.8	149.2	203.2	69.9	2½-16	28.6	19.1	44.5	1-8 x 19.1	6.4	50.8	20.3	659	14.2	4.0
15	104.8	C154C	211.4	200.0	304.8	69.9	2½-16	28.6	19.1	44.5	1-8 x 19.1	6.4	50.8	20.3	659	14.2	5.2
15	155.6	C156C	314.7	271.4	427.0	69.9	2½-16	28.6	19.1	44.5	1-8 x 19.1	6.4	50.8	20.3	659	14.2	6.9
15	206.4	C158C	417.9	322.2	528.6	69.9	2½-16	28.6	19.1	44.5	1-8 x 19.1	6.4	50.8	20.3	659	14.2	8.1
15	257.2	C1510C	521.2	373.0	630.2	69.9	2½-16	28.6	19.1	44.5	1-8 x 19.1	6.4	50.8	20.3	659	14.2	9.4
15	308.0	C1512C	624.5	423.8	731.8	69.9	2½-16	28.6	19.1	44.5	1-8 x 19.1	6.4	50.8	20.3	659	14.2	10.5
15	358.8	C1514C	727.7	474.6	833.4	69.9	2½-16	28.6	19.1	44.5	1-8 x 19.1	6.4	50.8	20.3	659	14.2	11.8
15	406.4	C1516C	824.4	522.3	928.7	69.9	2½-16	28.6	19.1	44.5	1-8 x 19.1	6.4	50.8	20.3	659	14.2	12.8
25	25.4	C251C	83.6	139.7	165.1	85.7	3¾-12	49.2	25.4	57.2	1½-16 x 25.4	9.5	65.1	33.2	669	23.4	5.4
25	50.8	C252C	168.8	165.1	215.9	85.7	3¾-12	49.2	25.4	57.2	1½-16 x 25.4	9.5	65.1	33.2	669	23.4	6.3
25	101.6	C254C	337.6	215.9	317.5	85.7	3¾-12	49.2	25.4	57.2	1½-16 x 25.4	9.5	65.1	33.2	669	23.4	8.0
25	158.8	C256C	527.8	273.1	431.8	85.7	3¾-12	49.2	25.4	57.2	1½-16 x 25.4	9.5	65.1	33.2	669	23.4	9.8
25	209.6	C258C	696.6	323.9	533.4	85.7	3¾-12	49.2	25.4	57.2	1½-16 x 25.4	9.5	65.1	33.2	669	23.4	11.6
25	260.4	C2510C	865.4	374.7	635.0	85.7	3¾-12	49.2	25.4	57.2	1½-16 x 25.4	9.5	65.1	33.2	669	23.4	13.3
25	311.2	C2512C	1,035.8	425.5	736.6	85.7	3¾-12	49.2	25.4	57.2	1½-16 x 25.4	9.5	65.1	33.2	669	23.4	15.0
25	362.0	C2514C	1,204.7	476.3	838.2	85.7	3¾-12	49.2	25.4	57.2	1½-16 x 25.4	9.5	65.1	33.2	669	23.4	16.7
55	50.8	C552C	362.2	174.6	225.4	127.0	5-12	55.6	34.9	79.4	None	3.2	95.3	71.2	687	50.1	14.7
55	108.0	C554C	768.7	231.8	339.7	127.0	5-12	55.6	34.9	79.4	None	3.2	95.3	71.2	687	50.1	18.7
55	158.8	C556C	1,130.9	282.6	441.3	127.0	5-12	55.6	34.9	79.4	None	3.2	95.3	71.2	687	50.1	23.1
55	260.4	C5510C	1,855.3	384.2	644.5	127.0	5-12	55.6	34.9	79.4	None	3.2	95.3	71.2	687	50.1	30.4
55	336.6	C5513C	2,397.9	460.4	796.9	127.0	5-12	55.6	34.9	79.4	None	3.2	95.3	71.2	687	50.1	35.3
75	155.6	C756C	1,596.4	314.3	469.9	146.1	5¾-12	44.5	31.8	95.3	None	3.2	114.3	102.6	651	72.1	33.3
75	333.4	C7513C	3,420.6	492.1	825.5	146.1	5¾-12	44.5	31.8	95.3	None	3.2	114.3	102.6	651	72.1	49.6
100	50.8	C1002C	675.3	219.1	269.9	158.8	6¾-12	57.2	41.3	104.8	None	3.2	130.2	133.0	669	93.6	28.5
100	168.3	C1006C	2,245.4	336.6	504.8	158.8	6¾-12	57.2	41.3	104.8	None	3.2	130.2	133.0	669	93.6	41.2
100	260.4	C10010C	3,466.5	428.6	689.0	158.8	6¾-12	57.2	41.3	104.8	None	3.2	130.2	133.0	669	93.6	51.2